

#### INTRODUCTION:

Adam Tech USB, Mini USB & Micro USB (Universal Serial Bus) and IEEE 1394 (Firewire) Series connectors are a complete line of shielded, hot pluggable, high speed I/O interface connectors available in a variety of body styles, sizes, positions and mounting orientations. Each is shielded for superior EMI/RFI protection and features spring contacts for exceptional connectivity properties. Specially designed shells with flares eliminate misconnection and kinked boardlocks add a strong, stable PCB attachment. An ideal solution for a low cost, high speed connection to peripheral devices.

#### FEATURES:

- USB-IF Compatible
- High Speed I/O applications
- Variety of Circuit sizes
- Variety of Body Styles
- Standard and Mini versions
- Shielded for EMI/RFI protection

#### MATING CONNECTORS:

Adam Tech USB, Mini USB & Micro USB and IEEE 1394 series connectors and all industry standard USB and IEEE 1394 connectors.

#### SPECIFICATIONS:

##### Material:

Standard insulator: PBT, Glass filled, rated UL94V-0  
 Optional Hi-Temp insulator: Nylon PA9T, rated UL94V-0  
 Insulator Color: Black (White optional)  
 Contacts: Phosphor Bronze or Brass  
 Shell: Steel, nickel plated

##### Contact Plating:

Gold over Nickel on mating area,  
 Tin over Copper underplate on tails

##### Electrical:

Operating Voltage: 30V AC  
 Current Rating: 1 Amp max.  
 Contact Resistance: 30 mΩ max.  
 Insulation Resistance: 1000 MΩ min.  
 Dielectric Withstanding Voltage: 100V AC for 1 minute

##### Mechanical:

Insertion force: 3 oz max.  
 Withdrawal force: 0.5 oz min.

##### Temperature Ratings:

Operating Temperature: -55°C to +85°C  
 Soldering process temperature:  
 Standard insulator: 235°C  
 Hi-Temp insulator: 260°C

##### PACKAGING:

Anti-ESD plastic trays or tubes

##### APPROVALS AND CERTIFICATIONS:

UL Recognized & CSA Certified, File no. E224053

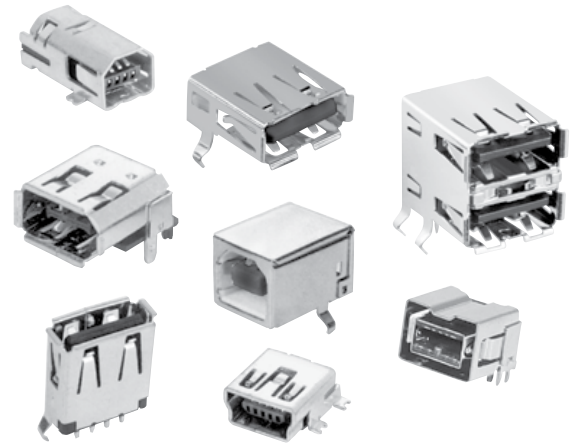

#### ORDERING INFORMATION

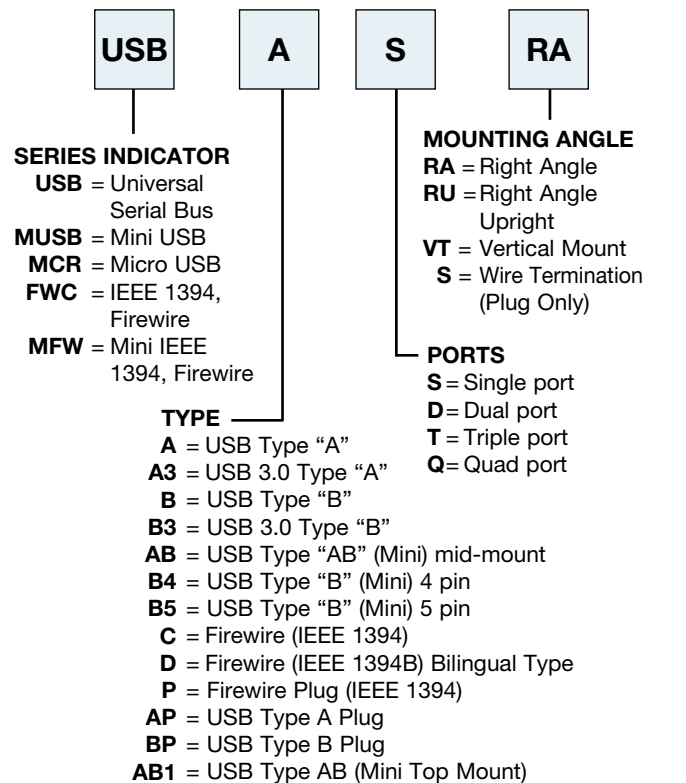

#### OPTIONS:

Add as Suffix to basic part no.

- SMT** = Surface Mount Leads with Hi-Temp insulator for Hi-Temp soldering processes up to 260°C
- TSMT** = True Surface Mount Leads with Hi-Temp insulator for Hi-Temp soldering processes up to 260°C
- 30** = 30 μin gold plating in contact area
- WT** = White color insulator
- HT** = Hi-Temp insulator for Hi-Temp soldering processes up to 260°C (Add this option for thru-hole products only. All SMT products are manufactured with Hi-Temp insulators)
- T/R** = Tape & Reel packaging

### USB 3.0, TYPE A RIGHT ANGLE THRU-HOLE

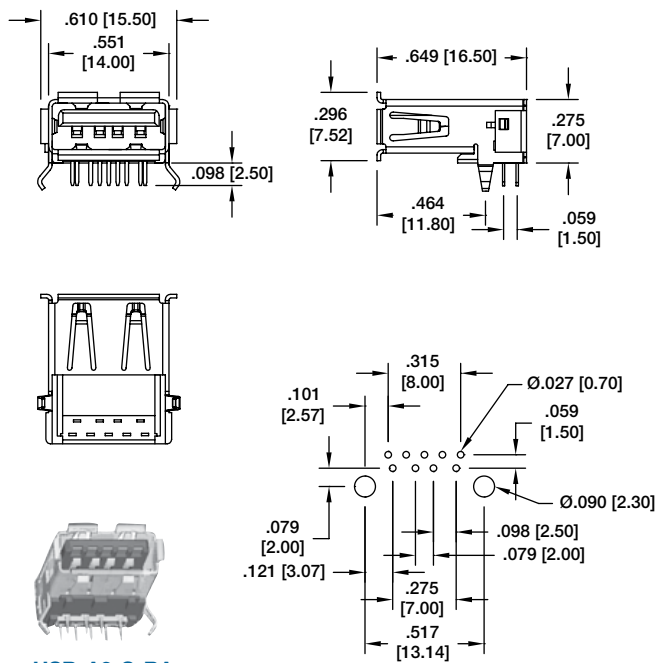

USB-A3-S-RA

Recommended PCB Layout

### USB 3.0, TYPE A PLUG

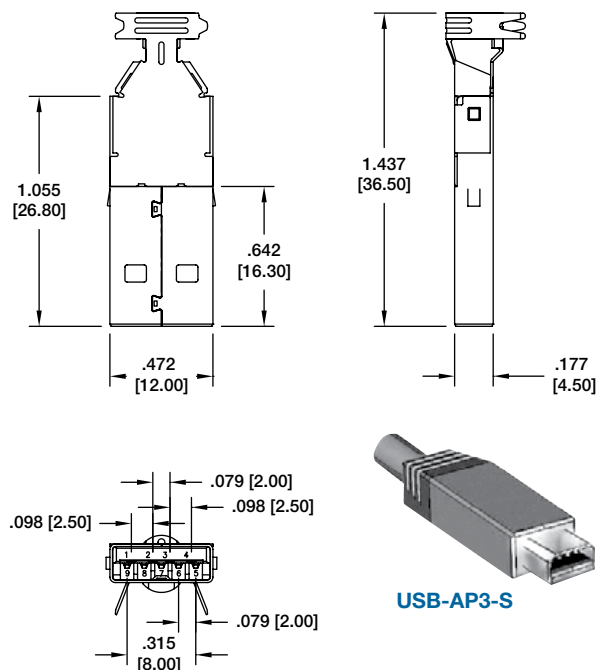

USB-AP3-S

### USB 3.0, TYPE B RIGHT ANGLE THRU-HOLE

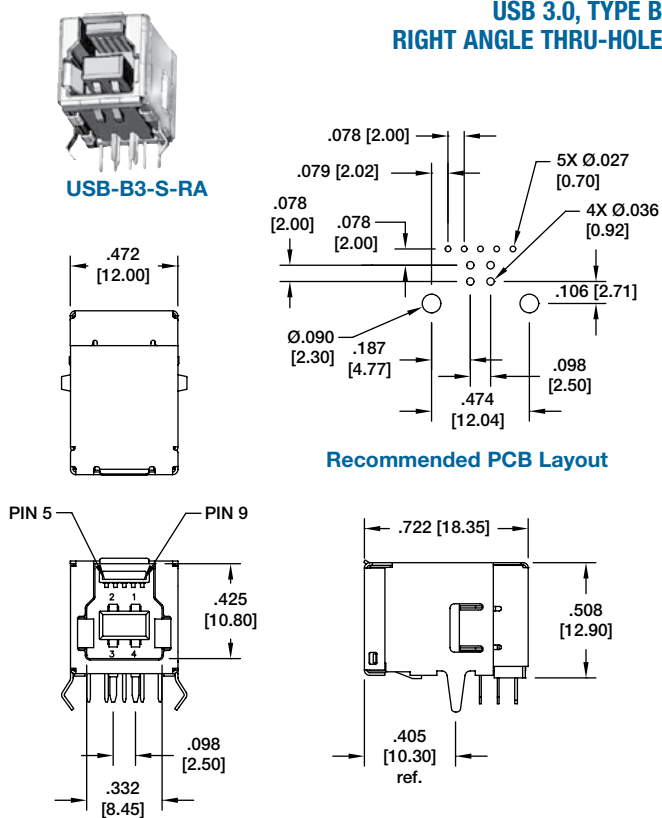

USB-B3-S-RA

Recommended PCB Layout

### USB 3.0, TYPE B PLUG

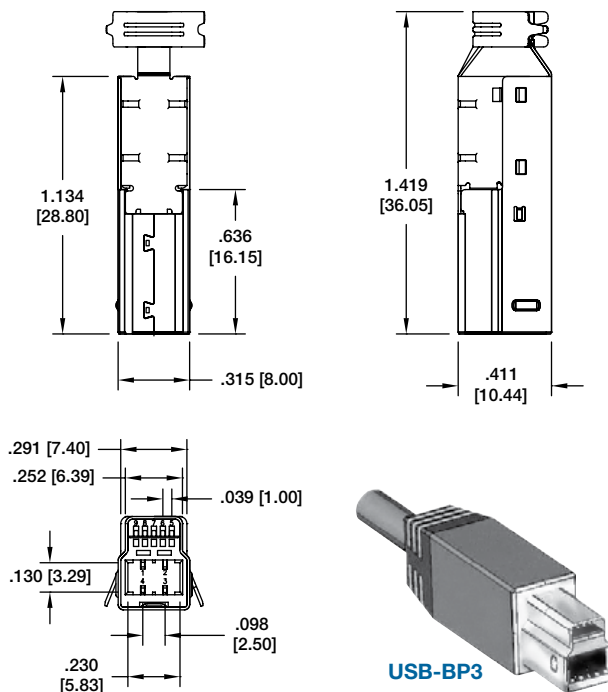

USB-BP3

### USB 2.0, TYPE A RIGHT ANGLE THRU-HOLE

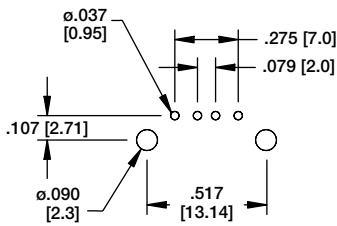
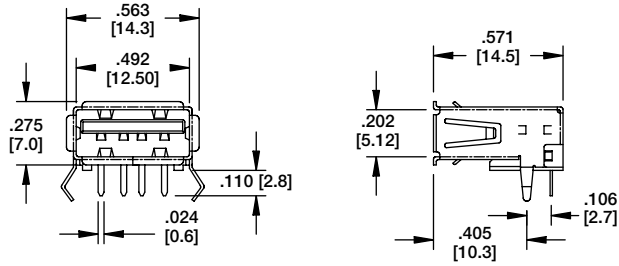

Recommended PCB Layout



USB-A-S-RA

### USB 2.0, TYPE A RIGHT ANGLE SMT

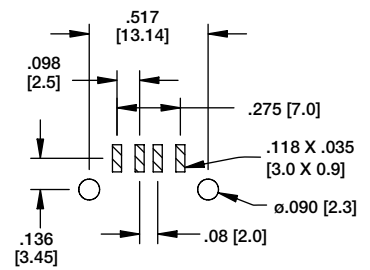
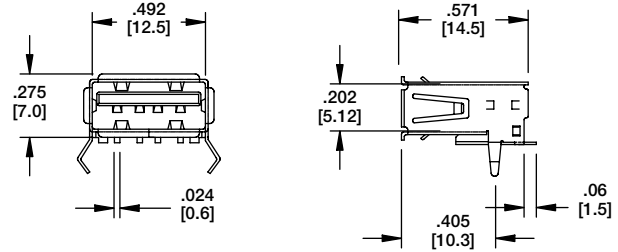

Recommended PCB Layout



USB-A-S-RA-SMT

### USB 2.0, TYPE A VERTICAL THRU-HOLE

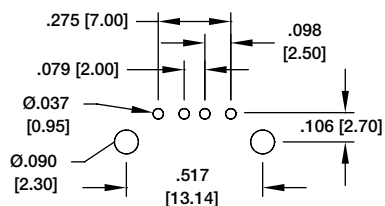
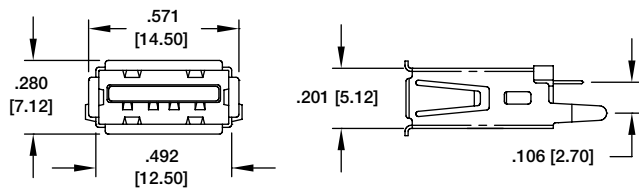
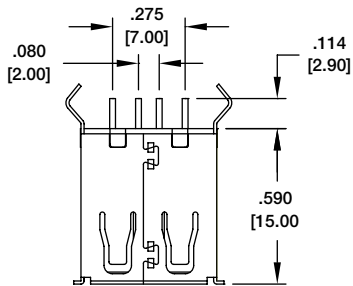

Recommended PCB Layout



USB-A-S-VT

### USB 2.0, TYPE A RIGHT ANGLE TRUE SMT

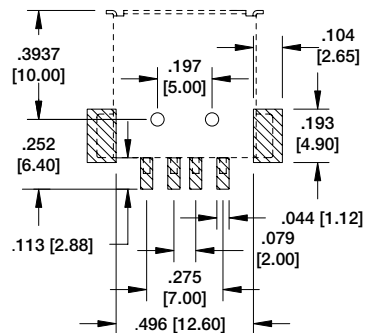
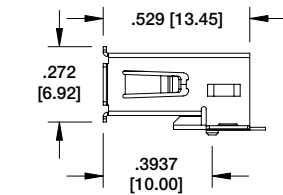
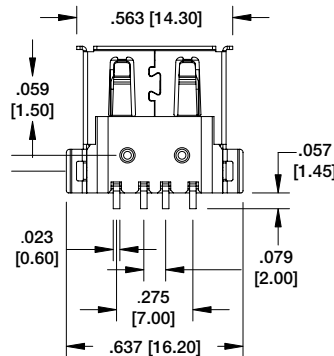
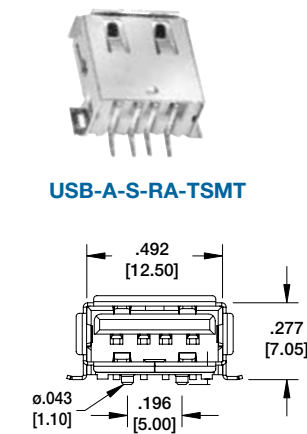

Recommended PCB Layout

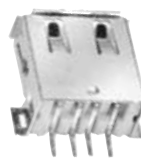

USB-A-S-RA-TSMT

#### USB 2.0, TYPE A ANGLE UPRIGHT, THRU-HOLE

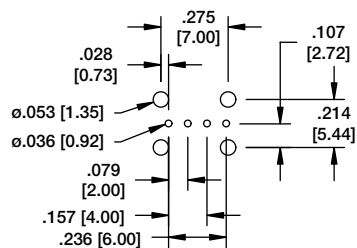
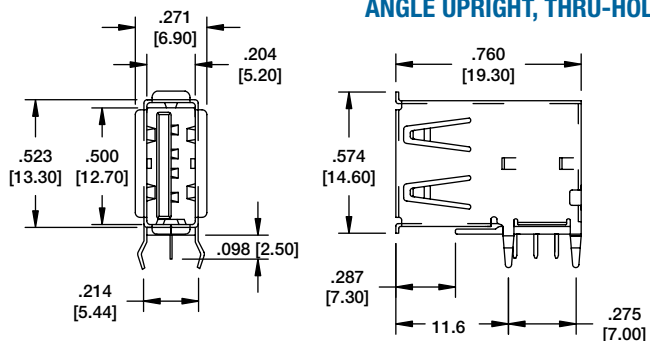

Recommended PCB Layout



USB-A-S-RU

#### USB 2.0, TYPE A RIGHT ANGLE, THRU-HOLE

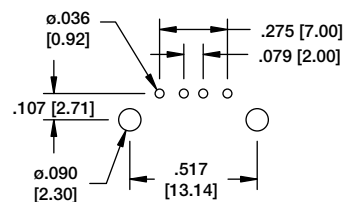
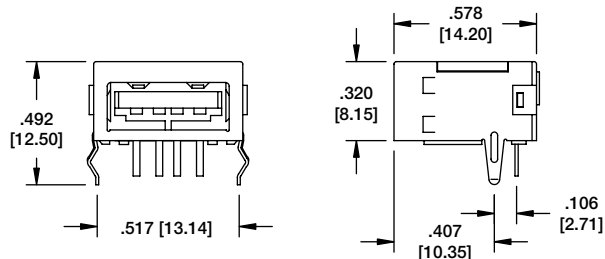

Recommended PCB Layout



USB-A-S-RA-FS

#### USB 2.0, TYPE A PLUG RIGHT ANGLE, THRU-HOLE

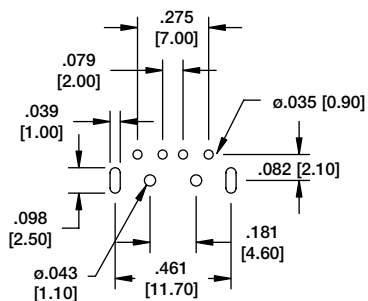
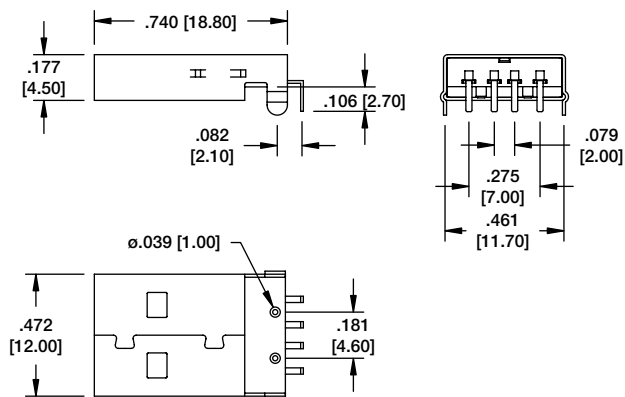

Recommended PCB Layout



USB-AP-S-RA

#### USB 2.0, TYPE A PLUG RIGHT ANGLE, SMT

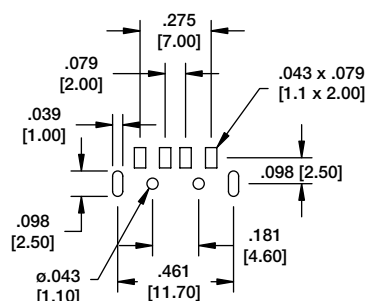
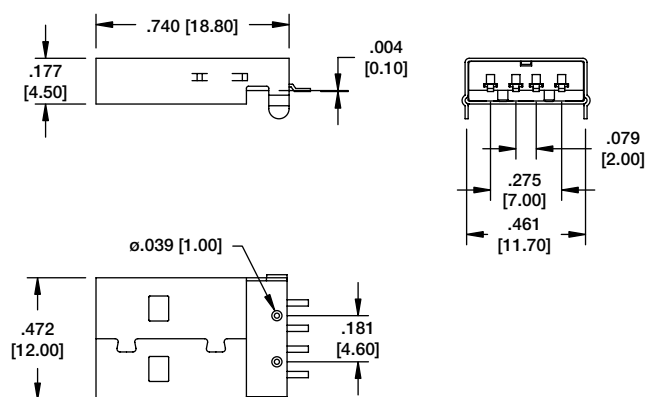

Recommended PCB Layout



USB-AP-S-RA-SMT

### USB 2.0, TYPE A, 2 PORT STACKED, RIGHT ANGLE, THRU-HOLE

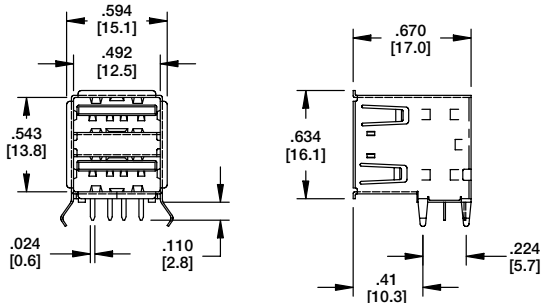

**USB-A-D-RA**

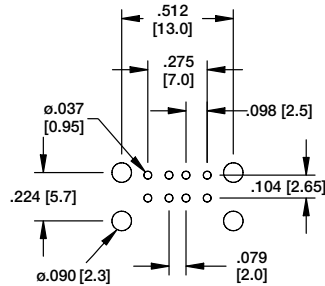

**Recommended PCB Layout (Bottom View)**

### USB 2.0, TYPE A, 4 PORT STACKED, RIGHT ANGLE, THRU-HOLE

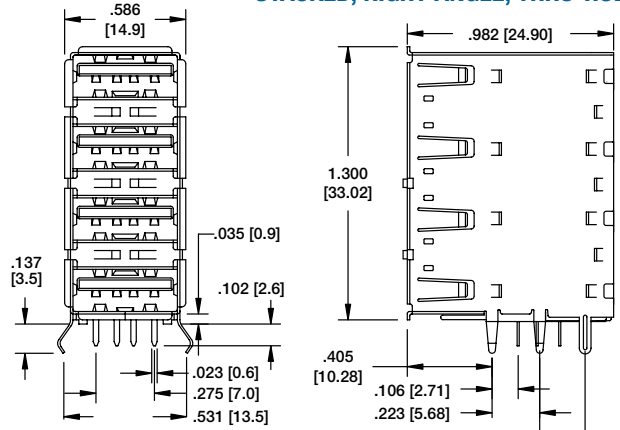

**USB-A-Q-RA**

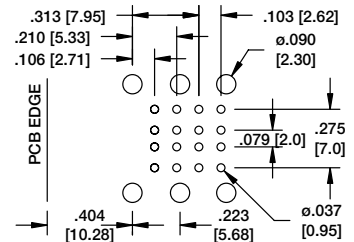

**Recommended PCB Layout**

### USB 2.0, TYPE A, 3 PORT STACKED, RIGHT ANGLE, THRU-HOLE

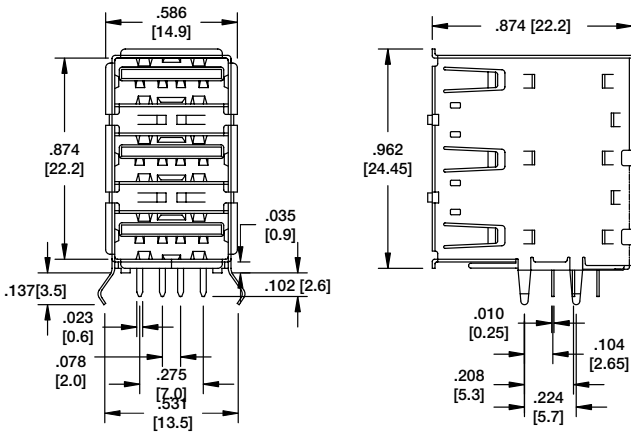

**USB-A-T-RA**

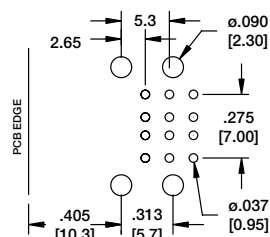

**Recommended PCB Layout (Bottom View)**

### USB 2.0, TYPE A, 2 PORT STACKED, VERTICAL, THRU-HOLE

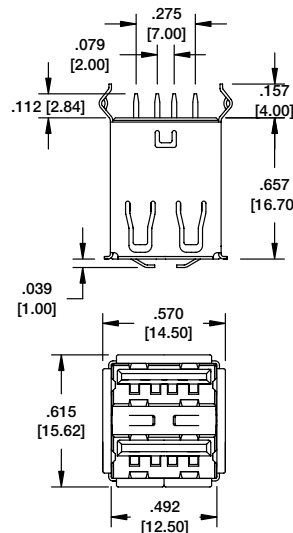

**USB-A-D-VT**

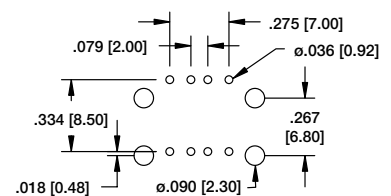

**Recommended PCB Layout**

### USB 2.0, TYPE B RIGHT ANGLE, THRU-HOLE

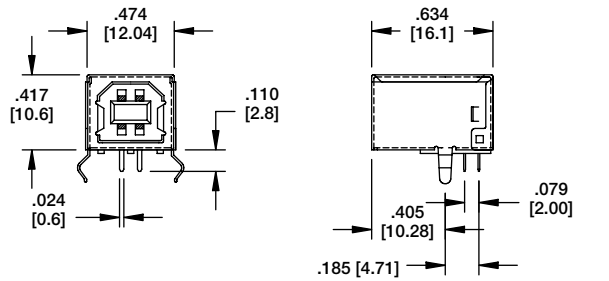

USB-B-S-RA

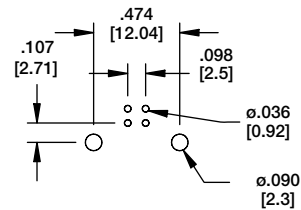

Recommended PCB Layout

### USB 2.0, TYPE B RIGHT ANGLE, TRUE SMT

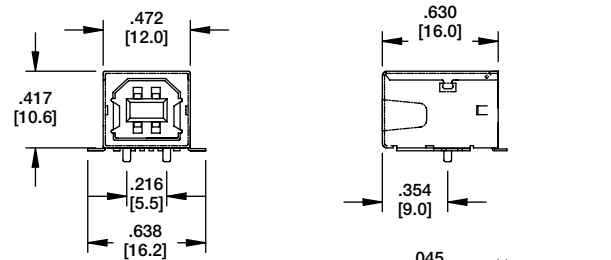

USB-B-S-RA-TSMT

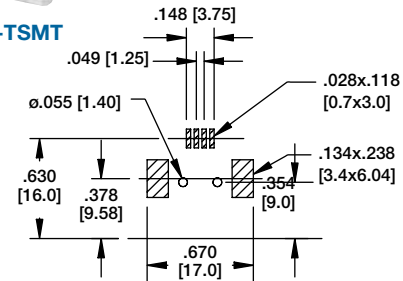

Recommended PCB Layout

### USB 2.0, TYPE B VERTICAL, THRU-HOLE

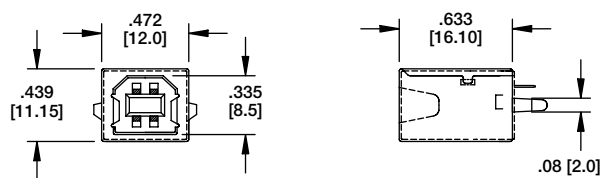

USB-B-S-VT

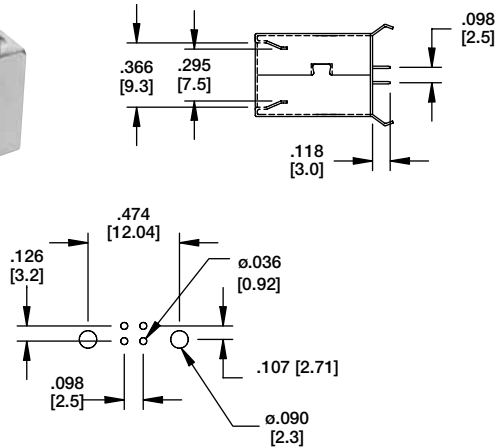

Recommended PCB Layout  
(Component Side)

### USB 2.0, TYPE B PLUG



USB-BP-S

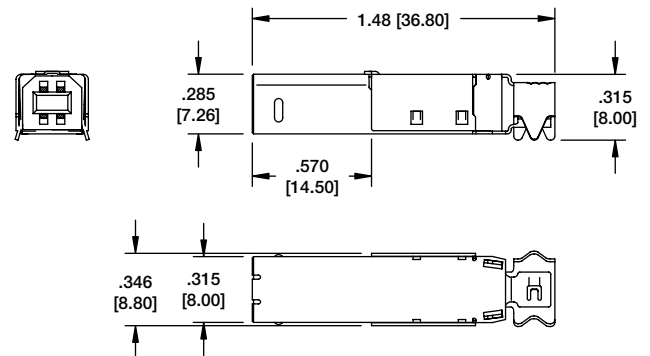

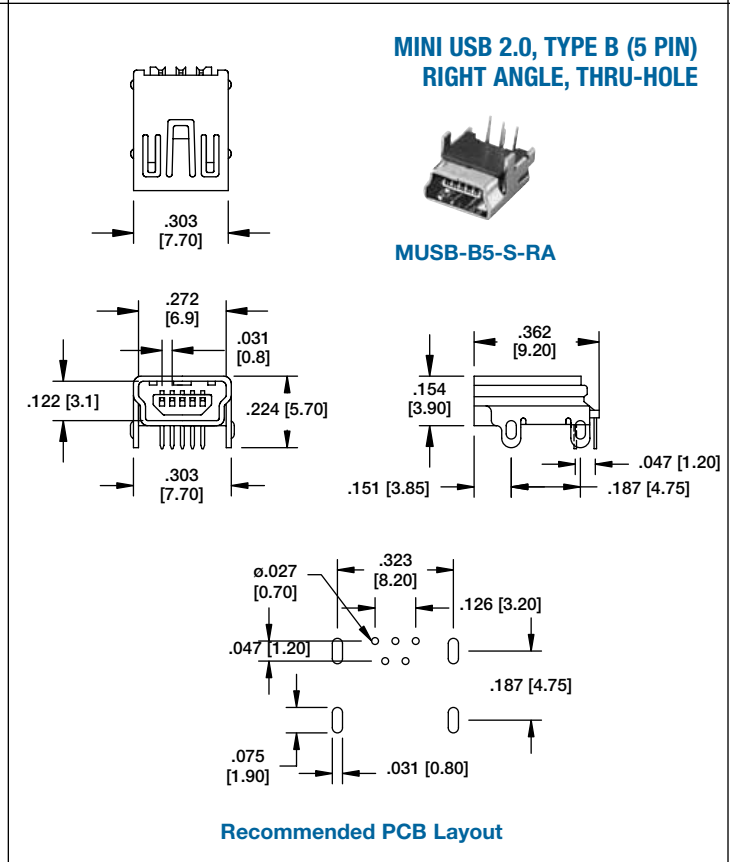
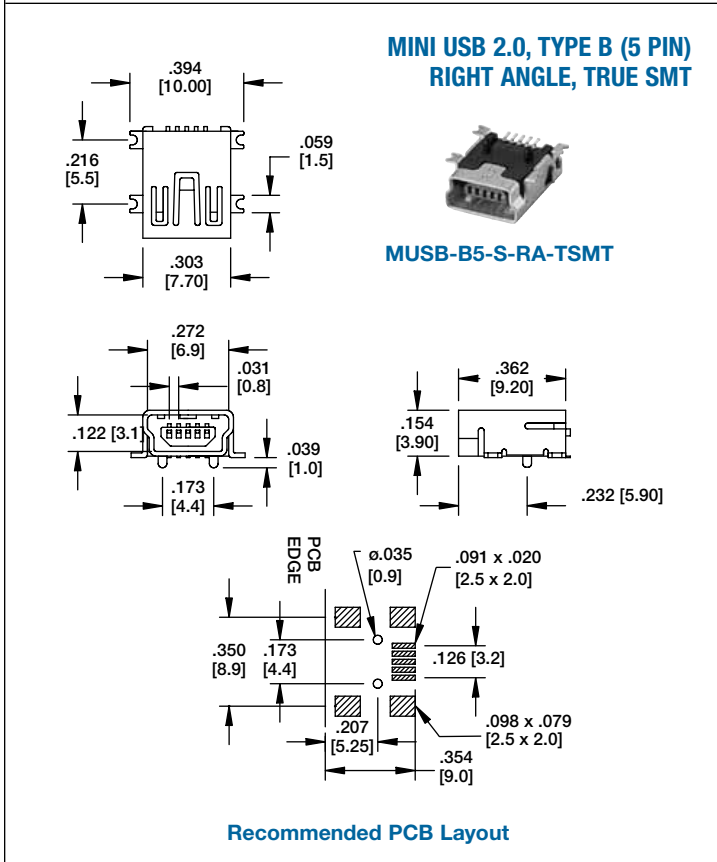
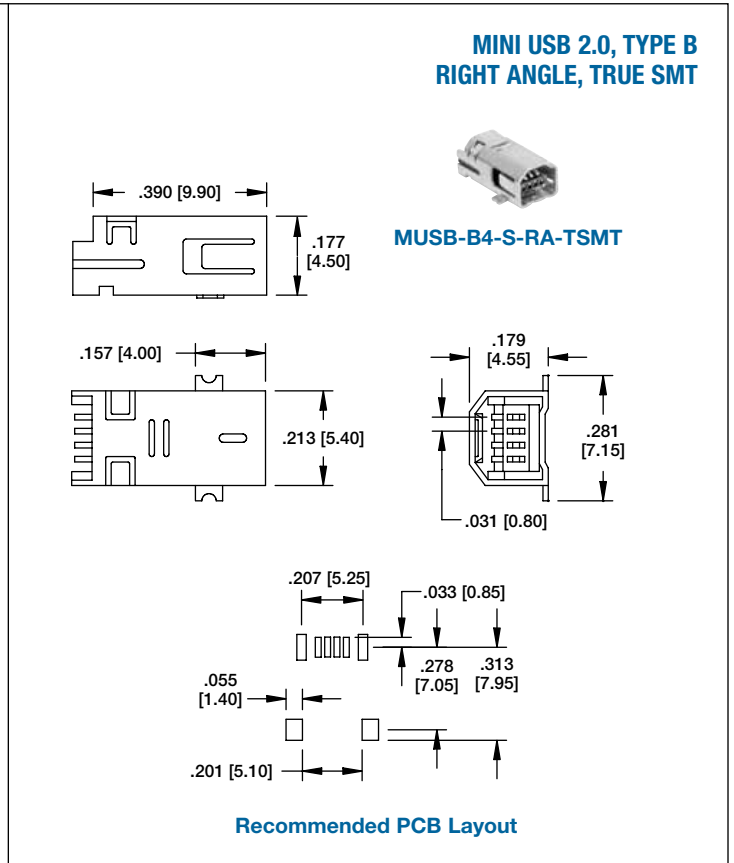
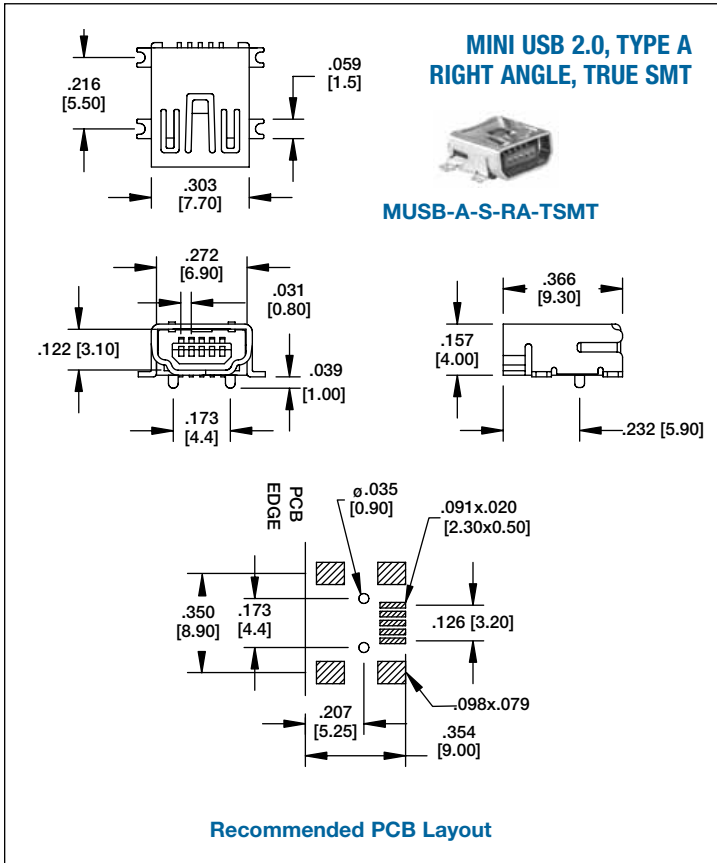

### MINI USB 2.0, TYPE AB RIGHT ANGLE MID MOUNT TRUE SMT

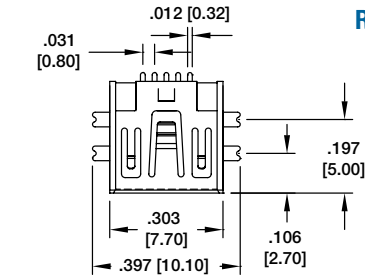

**MUSB-AB-S-RA-TSMT**

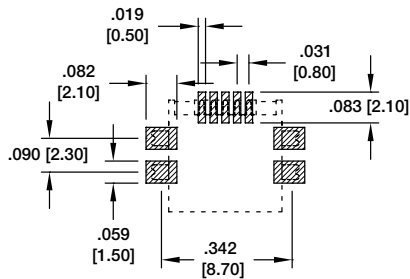
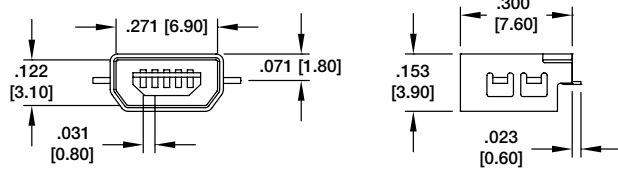

**Recommended PCB Layout**

### MINI USB 2.0, TYPE AB1 RIGHT ANGLE TRUE SMT

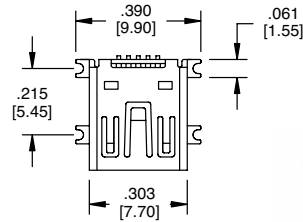

**MUSB-AB1-S-RA-TSMT**

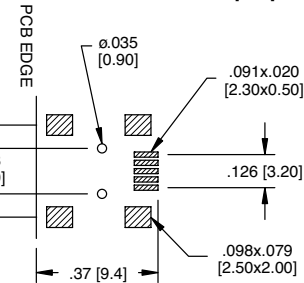
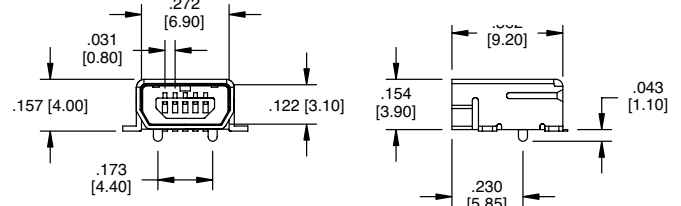

**Recommended PCB Layout**

### MINI USB 2.0, TYPE A4 RIGHT ANGLE, TRUE SMT

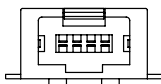
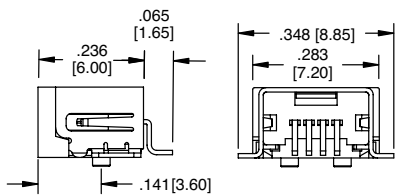

**MUSB-A4-S-RA-SMT-MK**

MIDDLE KEY

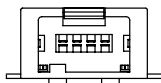

**MUSB-A4-S-RA-SMT-SK**

SINGLE KEY

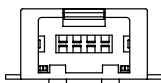

**MUSB-A4-S-RA-SMT-DK**

DUAL KEY

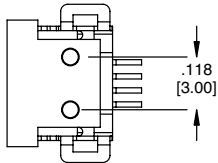

**MUSB-A4-S-RA-SMT-XX**

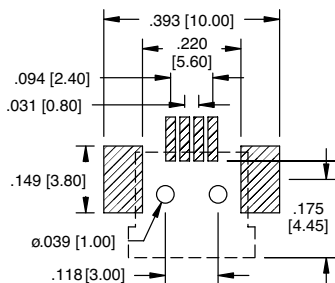

**Recommended PCB Layout**

### MINI USB 2.0, 8 PIN RIGHT ANGLE, SMT

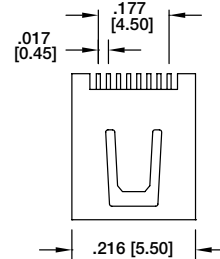

**MUSB-8P-S-RA-SMT**

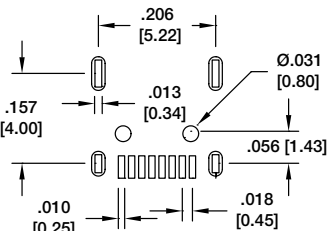
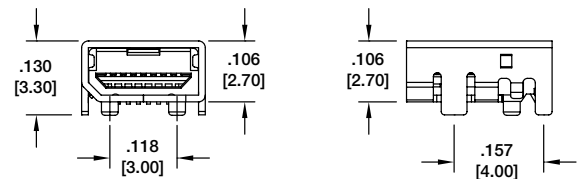

**Recommended PCB Layout**



